

Flange Size: 4" 150# RF
Bolt Circle: 7.5" Dia
Flange Dia: 9"

6 x 5mm x 12mm
Hex Cap Screws

Probe Lengths in Inches:
L = 12, 20, 30, 40, 60, 80, 100, 120, 140

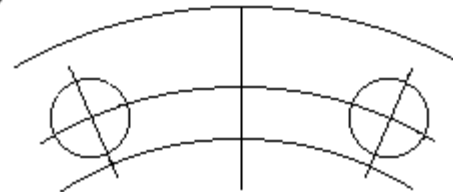

Bolt Patten

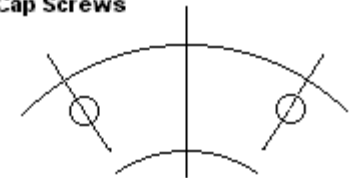

Bolt Patten

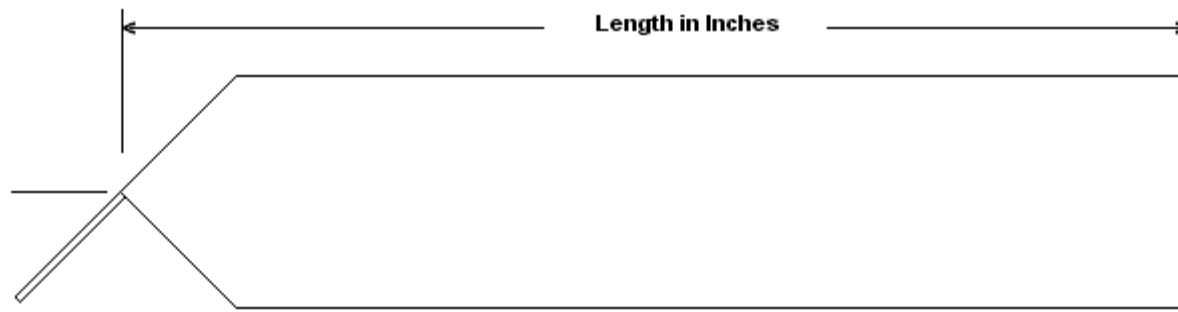

Side View

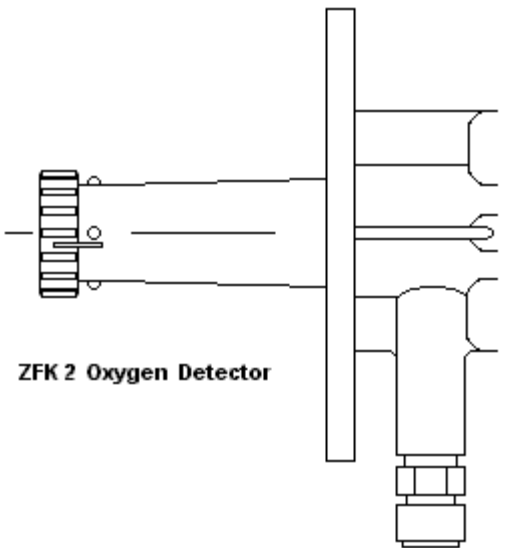

ZFK 2 Oxygen Detector

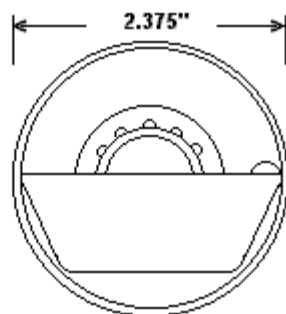

End View

Example Part Number:
12" Long = ZFK-P-012

Materials of Construction: 304 SS

DELTA INSTRUMENT LLC Northvale, NJ 07647.	
Job:	Rev: 0
ZFK - Probe	
ZFK-P-XXX - 00	Date: 03/10/04

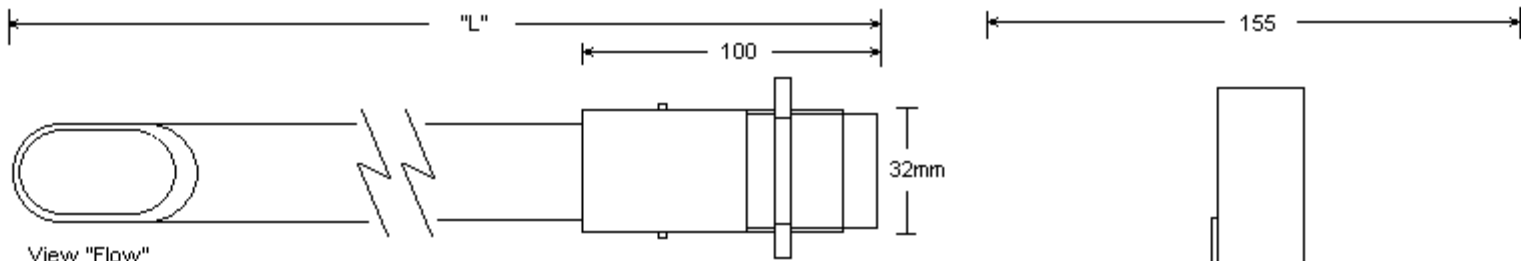

View "Flow"

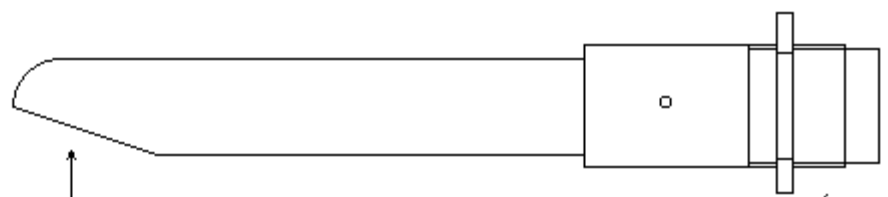

Flow

Locknut
Probe Holder

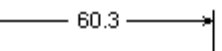
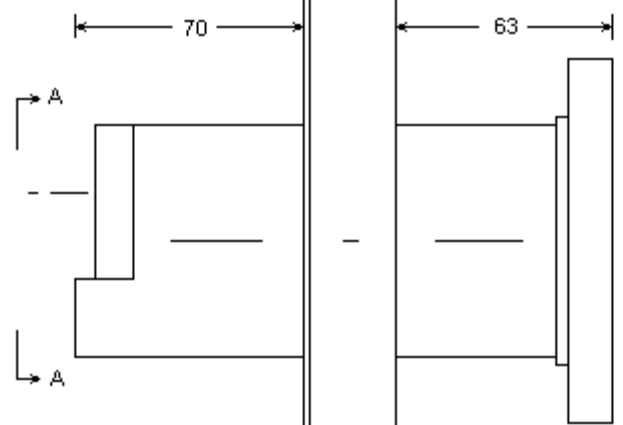

View "A-A"

Flange - 8 Bolt
4" 150lb RF S/S

Tube: 26x19mm

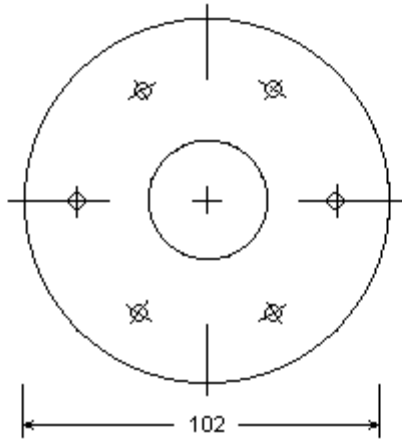

All Dimensions in mm

DELTA INSTRUMENT LLC	
Northvale, NJ 07647.	
Job:	Rev:
ZFK-ST Probe Arrangement	
Drawing# ZFK-ST-XXX	Date: 09/14/05

Flange Size: 4" 150# RF
Bolt Circle: 7.5" Dia
Flange Dia: 9"

Blow Down Air Port
1/2" NPT

6 x 5mm x 12mm
Hex Cap Screws

Probe Lengths in Inches:
L = 12, 20, 30, 40, 60, 80, 100, 120, 140

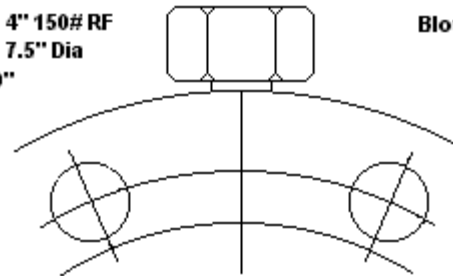

Bolt Patten

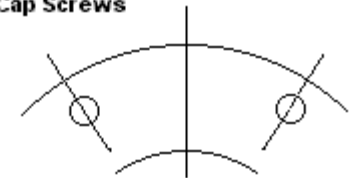

Bolt Patten

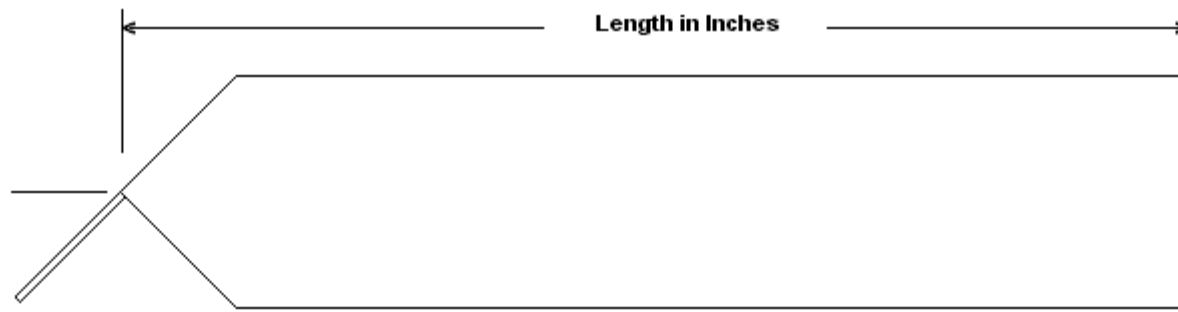

Side View

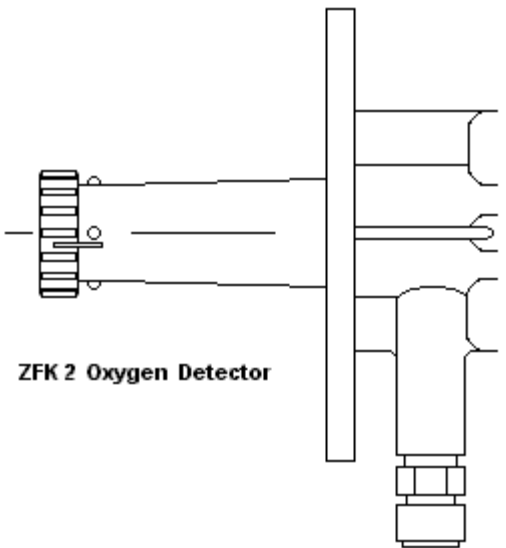

ZFK 2 Oxygen Detector

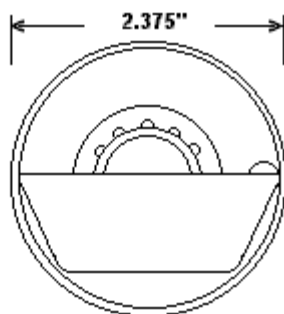

End View

Example Part Number:
12" Long = ZTB-P-012

Materials of Construction: 304 SS

DELTA INSTRUMENT LLC
Northvale, NJ 07647.

Job: _____ Rev: 0

ZTB - Probe With Blow Down

ZTB-P-XXX - 00 Date: 03/10/04

Note: Blow Down Air Supply Tubing
To Be 3/8" ID Minimum At 100 PSI

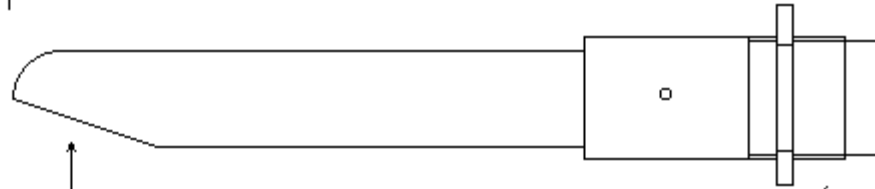
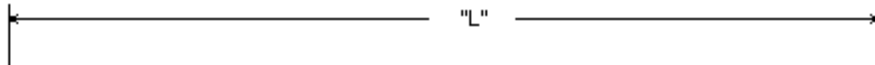
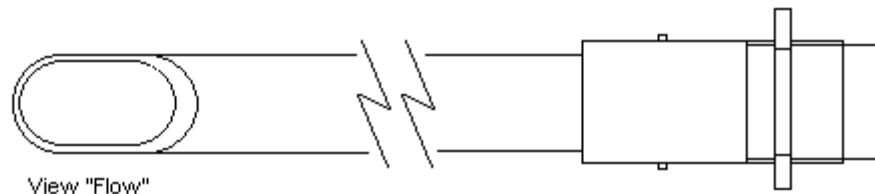

Flow

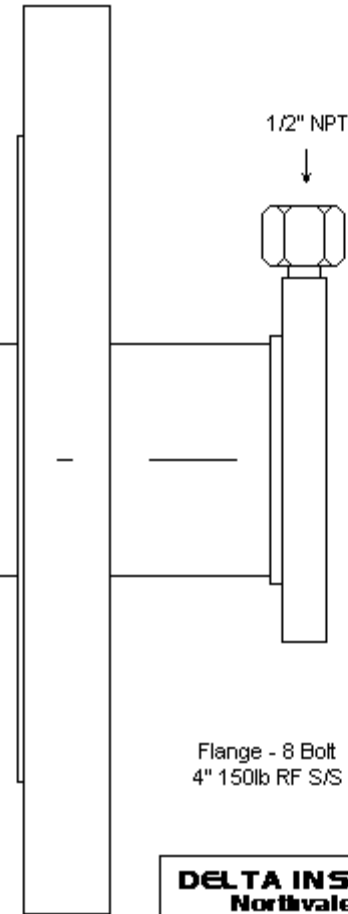
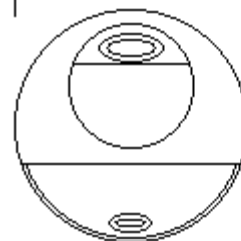
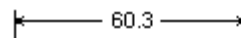
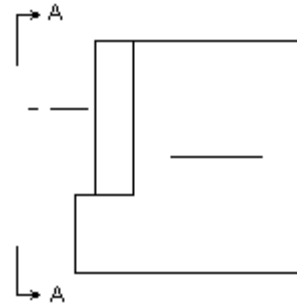
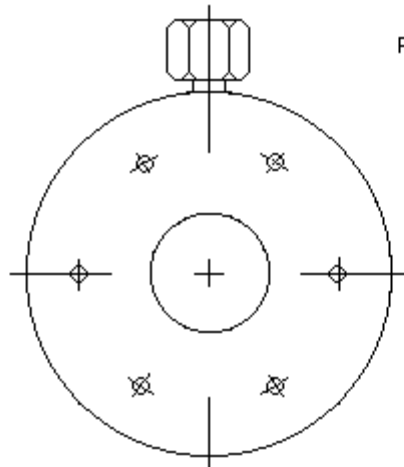

All Dimensions in mm

DELTA INSTRUMENT LLC Northvale, NJ 07647.	
Job:	Rev:
ZTB-ST Probe Arrangement	
Drawing# ZTB-ST-XXX	Date: 03/25/03

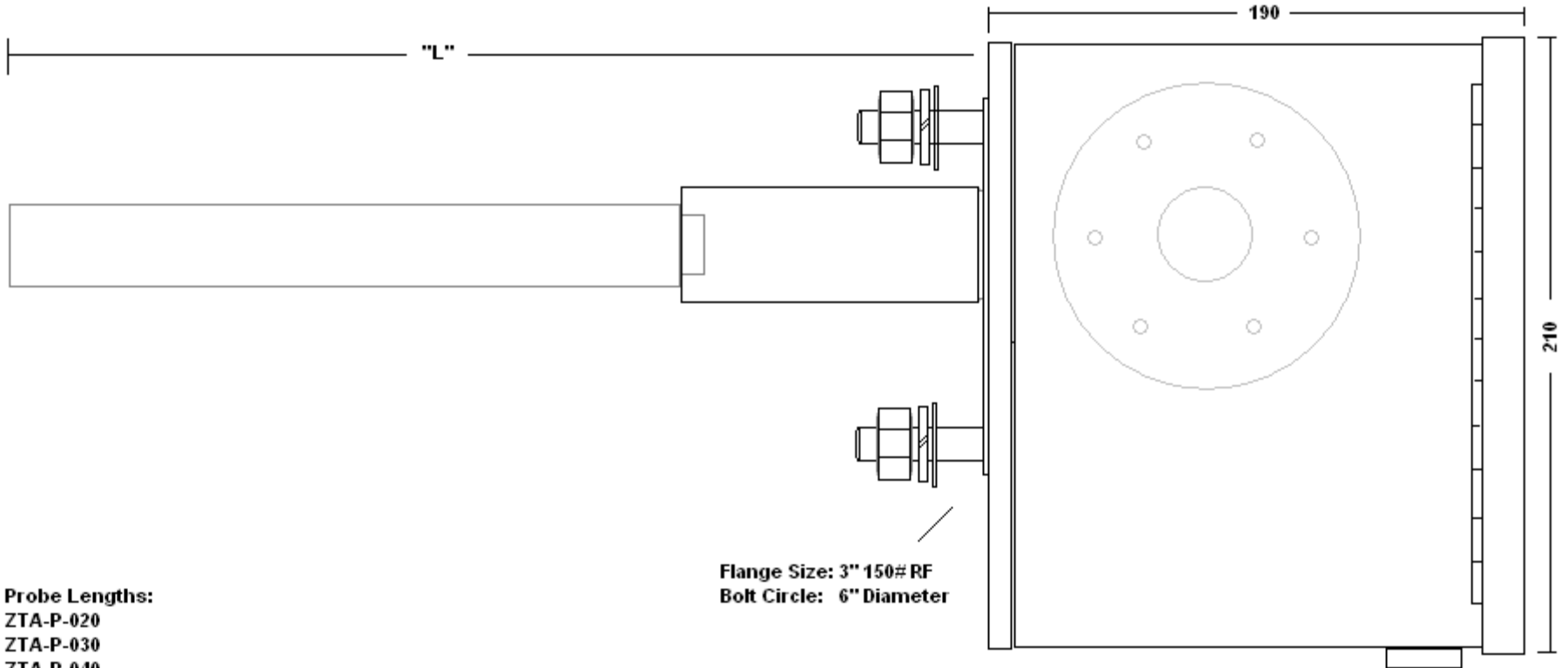

Probe Lengths:
 ZTA-P-020
 ZTA-P-030
 ZTA-P-040
 ZTA-P-060

Flange Size: 3" 150# RF
 Bolt Circle: 6" Diameter



Treaded Probe
 End: 1 1/4" IPT

Wetted Parts: Ceramic and 304 SS

Box Size: 210 x 190 x 161
 Materials of Construction: 304 SS

DELTA INSTRUMENT LLC Northvale, NJ 07647.	
Job:	Rev: 0
ZTA Probe Mounting Box	
ZTA-A-010	Date: 01/31/08